

LJ0.35 Action Plan

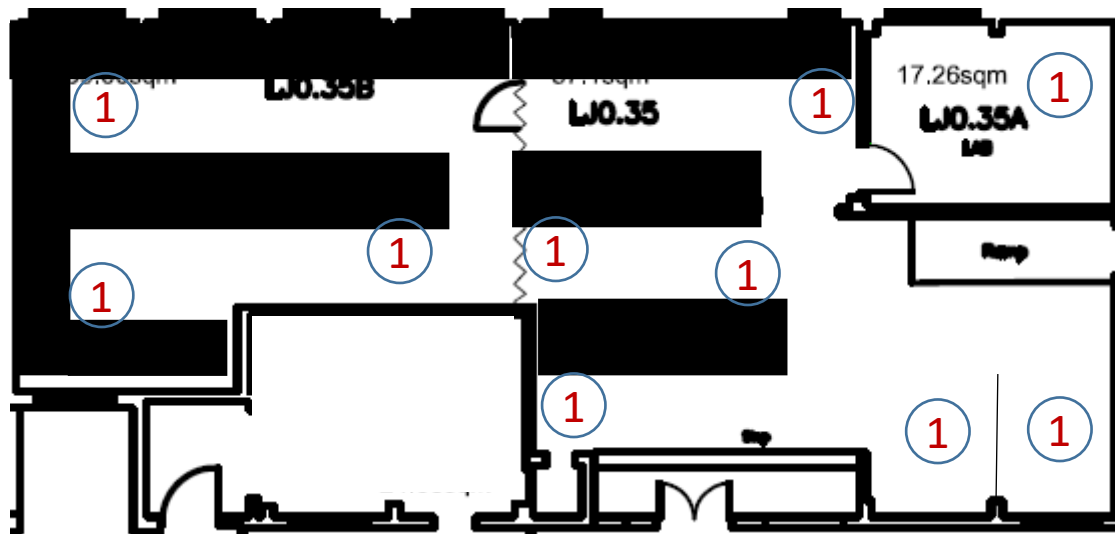

General Points

LJ0.35 will be used solely by 3rd year Physics project students.

The maximum capacity is 11 people, with a maximum of 10 students and minimum of 1 supervisor.

Students will be assigned their own workspace and should aim to spend the majority of their time in that work space and to minimize their circulation around the laboratory. A suggestion of how students could be positioned is labelled above however, other layouts are acceptable as long as a 2 m gap is maintained between all work areas.

In line with the university policy, students and staff will be expected to wear face masks and face shields at all times.

Access in and out will be via the main entrance to the lab and students will follow the wider Lennard-Jones building one-way system.

The Lennard-Jones building will remain locked so access to the building will be via a Keele Card, which will act as the contract tracing log for the building.

A hand sanitizer station will be positioned outside of the lab and cleaning supplies will be provided to sanitise benches/equipment as required within the laboratory.

NB: the air handling system within this laboratory has been passed by the Keele University estates team as "Covid secure".