

# COVID-19 CIRCULATION PLAN

## LEGEND

- Ⓢ Location of hand sanitiser station
- Ⓜ Location of door wedge
- WA 'Maintain social distance' wall sign.
- WC 'Staircase down only' wall sign.
- WD 'Give way to others' wall sign.
- WH 'One way system right arrow' wall sign.
- WJ 'Only one person in lift' wall sign.
- WL 'Opening times' wall sign.
- WM 'Sanitise hands' wall sign.
- WO 'Stop no exit' wall sign.
- WR 'Work together keep apart' wall sign.
- FD 'Staircase down only' floor sign.
- PB Push button

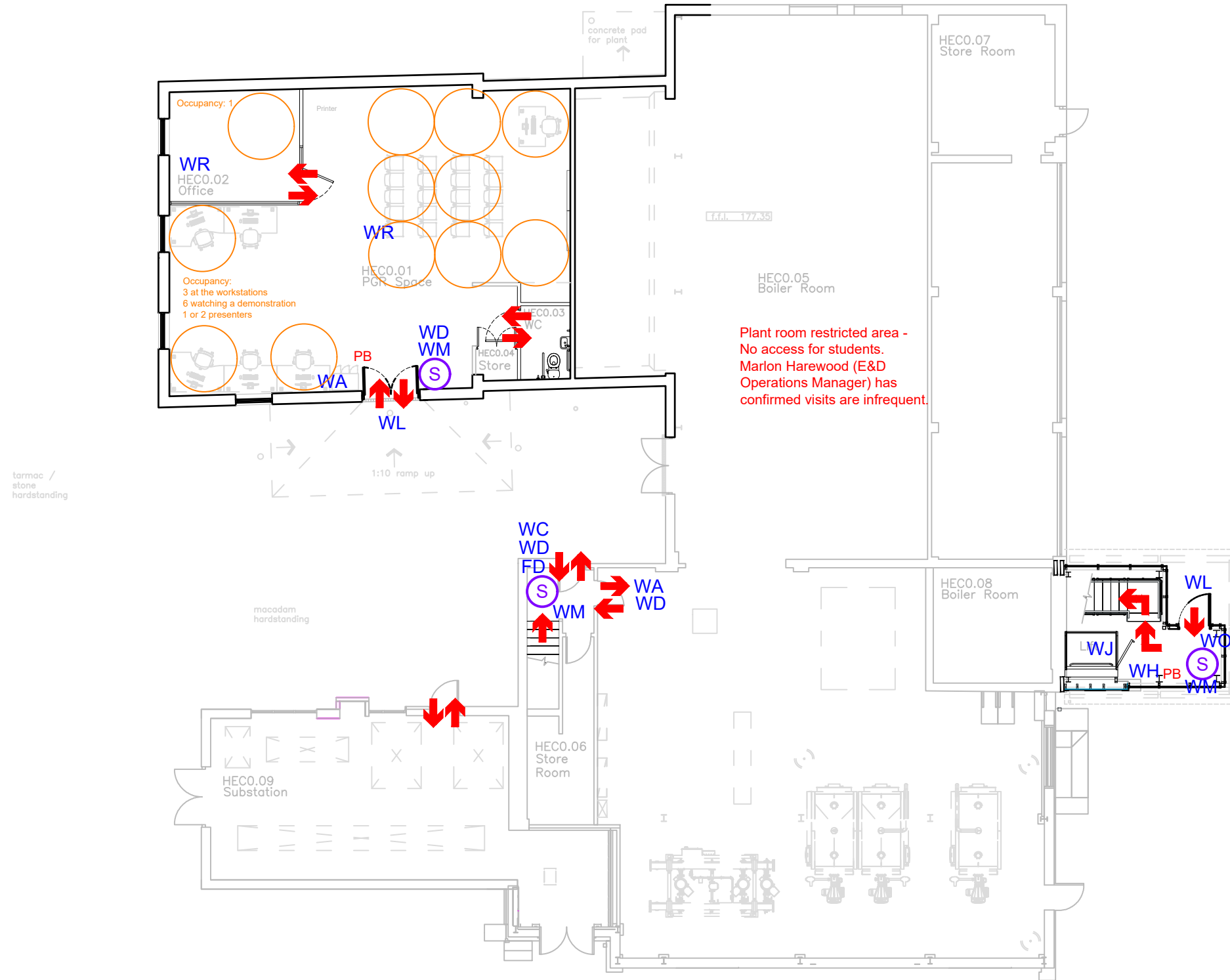

|   |                    |
|---|--------------------|
| PROJECT OFFICER<br>NAOMI ASHENDEN         |                    |
| PROJECT<br>HORWOOD ENERGY CENTRE          |                    |
| DESCRIPTION OF SHEET<br>GROUND FLOOR PLAN |                    |
| DRAWN BY<br>A DEAN                        |                    |
| DATE<br>JULY 2020                         |                    |
| SCALE<br>1:150 @ A3                       |                    |
| DRAWING NUMBER<br>B228-COVID19-000        |                    |
| REVISION                                  | DRAWING SIZE<br>A3 |

**DRAFT**



ESTATES & DEVELOPMENT  
DIRECTORATE  
KEELE  
STAFFORDSHIRE  
ST5 5BG