

Fire Escape Plan

The diagram is a vertical flowchart titled "FIRE ACTION" in large white letters on a blue background. Below the title, a blue box contains the text "If you discover or suspect a fire". The flowchart then branches into three main paths: 1. A red box with the instruction "Sound the alarm by operating the fire alarm call point" is preceded by a red square icon showing a hand pressing a bell. 2. A red box with the instruction "Do not attempt to fight the fire unless you are trained to do so" is preceded by a red square icon showing a fire extinguisher and flames. 3. A green box with the instruction "Immediately evacuate the area and close all doors to the space." is preceded by a green square icon showing a person running. Below the green box, a red box contains a list of three bullet points: "Do not take risks", "Do not stop to collect personal belongings", and "Do not re-enter the building for any reason unless authorised to do so", preceded by a red circle with a diagonal line. The flowchart then branches again: 4. A green box with the instruction "Report to the designated assembly point" is preceded by a green square icon showing three people walking towards a central point. Below this, a white box contains the text "Grassed Area Between Mackay and Chancellors". 5. A red box with the instruction "Contact Campus Safety Team 01782 733999 to confirm a fire alarm activation" is preceded by a red square icon showing a telephone handset and flames.

FIRE ACTION

If you discover or suspect a fire

Sound the alarm by operating the fire alarm call point

Do not attempt to fight the fire unless you are trained to do so

Immediately evacuate the area and close all doors to the space.

On activation of the fire alarm, you must leave the building immediately by the nearest safe available fire exit

- Do not take risks
- Do not stop to collect personal belongings
- Do not re-enter the building for any reason unless authorised to do so

Report to the designated assembly point

Grassed Area Between Mackay and Chancellors

Contact Campus Safety Team 01782 733999 to confirm a fire alarm activation

The diagram is a vertical flowchart titled "FIRE ACTION" in large white letters on a blue background. Below the title, a blue box contains the text "If you discover or suspect a fire". The flowchart then branches into three main paths: 1. A red box with the instruction "Sound the alarm by operating the fire alarm call point" is preceded by a red square icon showing a hand pressing a bell. 2. A red box with the instruction "Do not attempt to fight the fire unless you are trained to do so" is preceded by a red square icon showing a fire extinguisher and flames. 3. A green box with the instruction "Immediately evacuate the area and close all doors to the space." is preceded by a green square icon showing a person running. Below the green box, a red box contains a list of three bullet points: "Do not take risks", "Do not stop to collect personal belongings", and "Do not re-enter the building for any reason unless authorised to do so", preceded by a red circle with a diagonal line. The flowchart then branches again: 4. A green box with the instruction "Report to the designated assembly point" is preceded by a green square icon showing three people walking towards a central point. Below this, a white box contains the text "Grassed Area Between Mackay and Chancellors". 5. A red box with the instruction "Contact Campus Safety Team 01782 733999 to confirm a fire alarm activation" is preceded by a red square icon showing a telephone handset and flames.

FIRE ACTION

If you discover or suspect a fire

Sound the alarm by operating the fire alarm call point

Do not attempt to fight the fire unless you are trained to do so

Immediately evacuate the area and close all doors to the space.

On activation of the fire alarm, you must leave the building immediately by the nearest safe available fire exit

- Do not take risks
- Do not stop to collect personal belongings
- Do not re-enter the building for any reason unless authorised to do so

Report to the designated assembly point

Grassed Area Between Mackay and Chancellors

Contact Campus Safety Team 01782 733999 to confirm a fire alarm activation



 **Sound the alarm by operating the fire alarm call point**

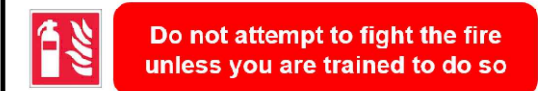

 **Do not attempt to fight the fire unless you are trained to do so**

 Immediately evacuate the area and close all doors to the space.

On activation of the fire alarm, you must leave the building immediately by the nearest safe available fire exit

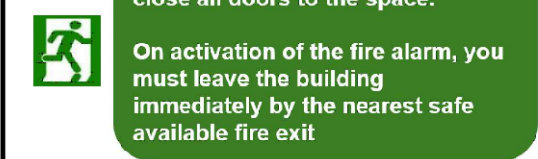

 On activation of the fire alarm, you must leave the building immediately by the nearest safe available fire exit

- Do not take risks
- Do not stop to collect personal belongings
- Do not re-enter the building for any reason unless authorised to do so

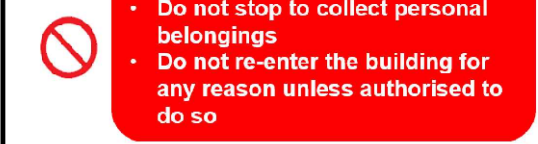

Report to the designated assembly point
Grassed Area Between Mackay and Chancellors



Report to the designated assembly point
Grassed Area Between Mackay and Chancellors

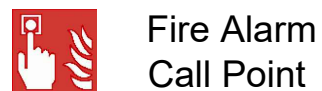
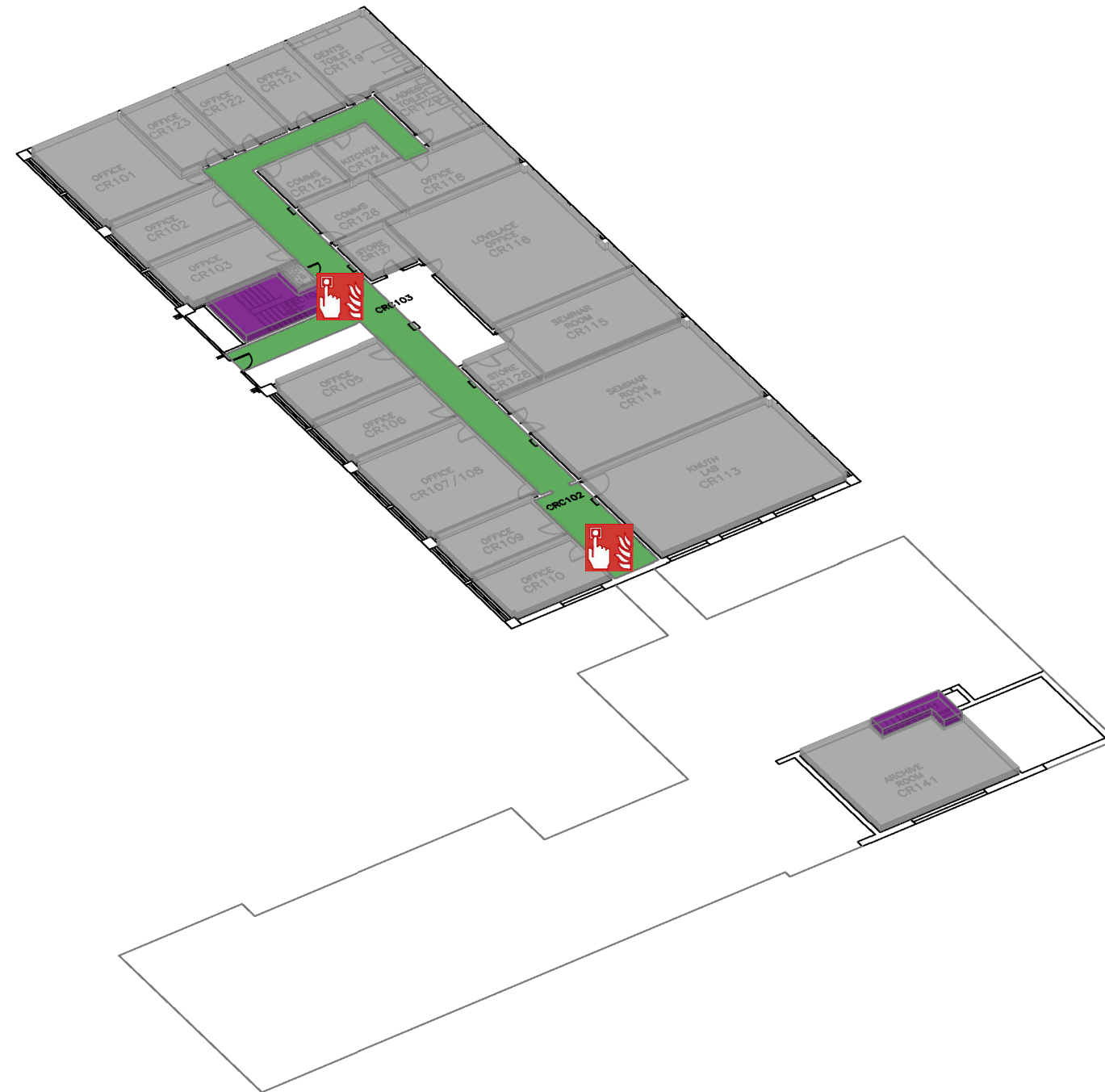
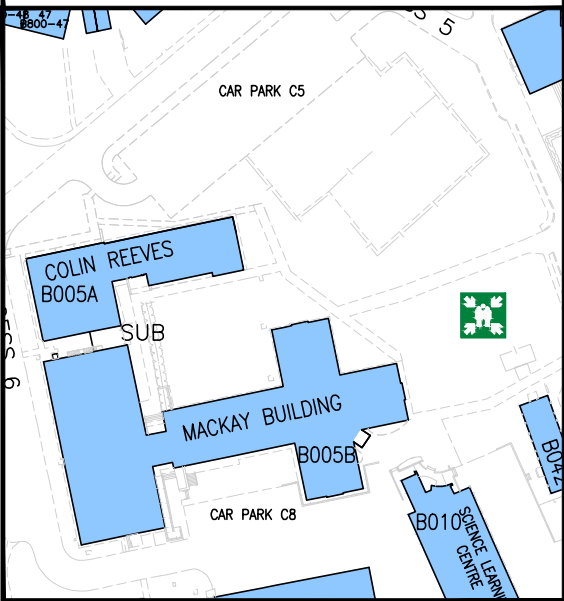

 **Contact Campus Safety Team
01782 733999 to confirm a fire
alarm activation**

[illegible]

 Fire Alarm
Call Point

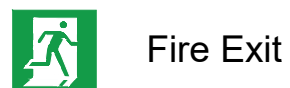

 Fire Exit



Assembly Point



Wheelchair Accessible
Fire Exit



 Fire Escape Route



 Fire Escape Stair



 Accessible WC

Keele
UNIVERSITY

